

**Proposed Project at Mouza-Ichlabad, J.L. No-75, L.R. Plot No-63, R.S. Plot No-43/2072, L.R. Khatian No-13866, 13982, 13983, 13985, 13986, 13987, 13988, Holding No-86, Ward No-10, Mahalla-Sripally, under Burdwan Municipality, P.S.-Burdwan, District-Purba Bardhaman**

---

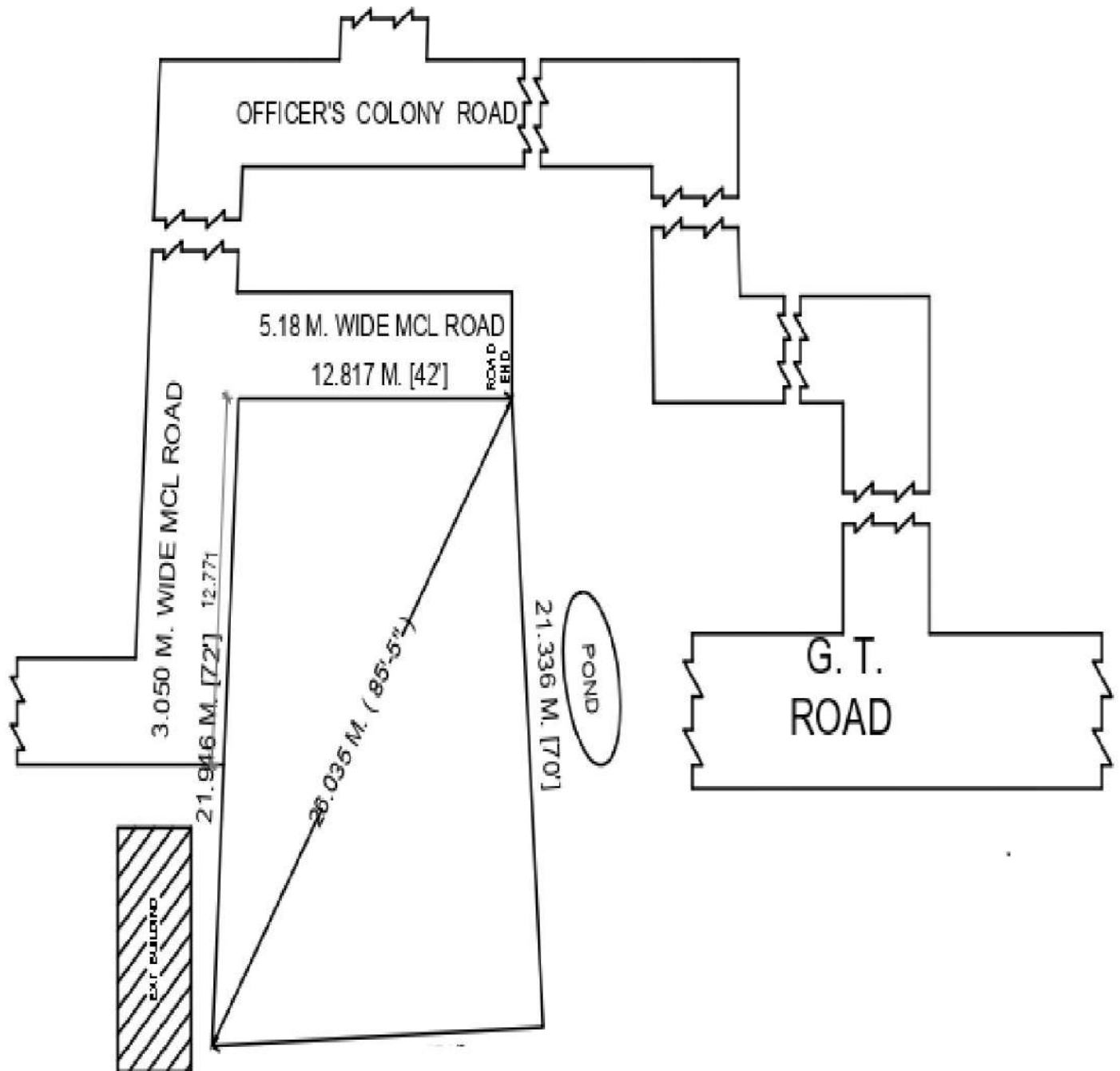

**LATITUDE : 23.247684**  
**LONGITUDE : 87.835221**

MAHAPRABHU CONSTRUCTION  
*Sambhu Nath Chandra*  
Partner

---

SIGNATURE OF OWNER